

## “The Riverway”

---

The City of Radford & Pathways has been awarded grants totaling \$1,025,000 from the Virginia Department of Transportation and the Federal Housing Administration to implement Radford’s Bikeway/Walkway network to be known as the “Riverway”.

The first Phases of the project include the planning, design, Right-of-way acquisitions, and construction of 14,637 linear feet (2.77 miles) of Bike lanes and walking trails. The “Riverway” will begin at Radford University and proceed west along the New River to Bisset Park, then turn South under West Main Street through Wildwood Park to Park Road. Connection points will be made to Wildwood Park, Main Street, and adjacent neighborhoods. The City of Radford’s Match on the first phases of the development is \$495,400. The City also received a 12.94 Acre donation of undeveloped open space necessary for construction of the Bikeway/Walkway from D.M.I. Corporation. The project, designed by Anderson & Association, was approved by VDOT in the spring of 2003. Construction on the project was begun in Mid September by Hall Construction and will be completed by Mid 2004.

The combined phases of the Riverway are designed to improve pedestrian safety, recognize the historical, economical and environmental significance of the New River, as well as improve Radford’s transportation Network. The trail concept has been recognized in the Radford Comprehensive Plan since 1990. The City & Pathways began initiating grant applications to make the concept a reality in 1998.

The City has also received \$179,407 to construct an urban trail extension from Bisset Park to Radford University along East Main Street. The additional 4,000 linear feet of trail will connect its users to the Central Business District. Design on the project is expected to begin this winter. Future phases of the trail will connect Bisset Park to Ingles Street, Ingles Street to McHarg Elementary School, and Wildwood Park to Rock Road.

**LEGEND**

- — — TRAIL PHASE 1
- — — TRAIL PHASE 2
- — — TRAIL PHASE 3
- — — TRAIL PHASE 4
- — — URBAN TRAIL EXTENSION

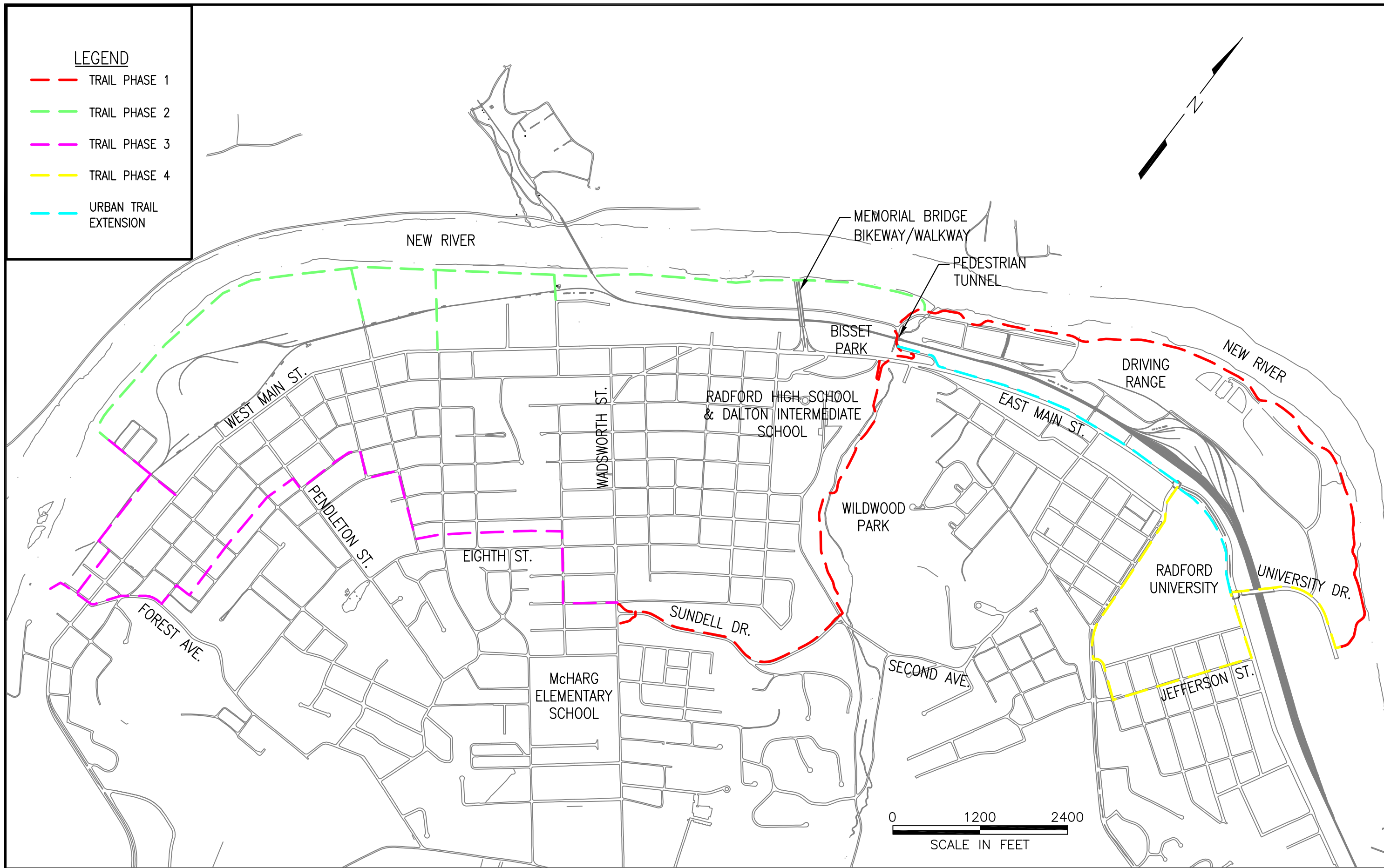
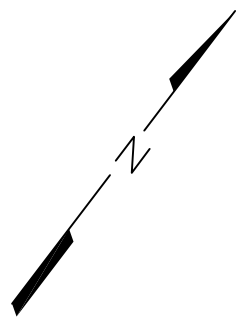

Jun 26, 2003 2:55pm / U:\21\21230\dwg\21230 overall trail plan.dwg: Layout